



Stores: ChelinoBaby – Ormonde – JHB
ChelinoBaby – Fourways – JHB
ChelinoBaby – Woodmead Square – JHB
ChelinoBaby – Greenstone – JHB
ChelinoBaby – Menlyn – Pretoria
ChelinoBaby – Kolonnade – Pretoria
ChelinoBaby – Centurion – Pretoria
ChelinoBaby – Gateway – Durban
ChelinoBaby – Online – www.chelinobaby.co.za



Imported for :
ChelinoBaby Group of Companies.
No. 12 Kimberlite Road , Theta Ext 5 ,
Booysens Reserve , JHB , 2091. SA.
Tel: +2711 8352520
Info: info@chelino.co.za

Chelino The Chelino logo icon, which is a red circle containing a stylized white face with a single eye and a smiling mouth.



DAYTONA STAGES II INSTRUCTION MANUAL

0-12

Car child safety seat
VEHICLE CRS
CHILD RESTRAINT System

Group: 0+, I, II, III
Weight: 0-36KG
Age: Birth-12-years-old

Thank You

You have purchased a high quality, fully certified child safety seat. This product is suitable for the use of children weighing UNDER 36 kg (approximately 12 years old or under). Carefully read this Instruction Manual and follow the installation steps because this is the ONLY way to protect your child from serious injury or death in case of an accident, and to provide comfort to your child while using this product. Keep this instruction manual for future reference.

Please Confirm

Please make sure that your vehicle is equipped with 3-point retractor safety-belt. Seat belts may be different in design and length according to make, manufacturing date, and type of the vehicle. This child seat is only suitable for use in the listed vehicles fitted with 3-point retractor safety-belts and approved to European Regulation No. 16 or other equivalent standards.

Product Information

This product has 2 kinds of installation methods for each mass group, relatively belongs to 2 categories, details as below:
Universal category, for all Group 0+ I II III, install the child restraint only by using the vehicle 3-point safety belts.
Semi-universal category, for Group 0+, install by ISOFIX+Top tether as the Semi-universal ISOFIX CRS; for Group I II III, install the child restraint by vehicle 3-point safety belts and additional attachments (ISOFIX).

Due to variation on the styles and designs of our products, the photographs and illustrations shown in this manual are generic. Therefore products fabric, colour and design may vary from images shown, Chelino reserves the right to alter products specifications

Content

Important notice before using	01
The constitute of Baby Car Seat	05
Installation position	07
Option of installation method	08
How to install ISOFIX	10
Group 0+ Installation with ISOFIX and top tether	11
Group I Installation with ISOFIX and Car belt	12
Installation of Group 0+(Use Car Belt)	14
Installation of Group I (Use car Belt).	16
Group 0+/1 To fix child	18
Installation of Group II/III	20
Unlock the ISOFIX connector.	21
To fix top tether correctly at rearward installation.	22
To adjust the angle of Baby Car Seat	23
To adjust five point harness system.	24
To adjust height of headrest	25
Transfer from Group I to Group II/III (conceal five point harness system).	25
Rotating/Switching the direction of baby car seat.	27
Remove/install the cover.	29
Maintaining/washing of baby car seat	31
The store of baby car seat.	32

Important notice before using

Warning!

To ensure maximum security for your child,
please read the following instruction carefully.

- 1.NO child restraint can guarantee full protection from injury in an accident. However, proper use of this child restraint will reduce the risk of serious injury or death to your child.
- 2.Please make sure that all users understand the installation method of this seat correctly.
- 3.This child restraint is designed only for child weighing under 36kg (approximately 12 years old or under).
- 4.DO NOT use forward facing mode before the child's weight exceeds 9kg.
- 5.Any straps holding the restraint to the vehicle should be tight, that any straps restraining the child should be adjusted to the child's body, and that straps should not be twisted.
- 6.DO NOT use or install this child restraint until you read and understand the instructions in this manual and in your vehicle owner's manual.
- 7.Read the instructions on ISOFIX fixed points in the car manufacturer's handbook carefully.
- 8.Concern the danger of making any alterations or additions to the device without the approval of the Type Approval Authority, and a danger of not following closely the installation instructions provided by the child restraint manufacturer.
- 9.DO NOT have your child in unfitted clothes when use this child restraint in baby or toddler mode, because this may prevent your child from being properly and securely fastened by the shoulder harnesses and the harnesses between thighs.

- 10.DO NOT use this child restraint if it has damaged or missing parts.
- 11.When use this child restraint in baby or toddler mode, the safety belt must be used correctly, and ensure that any lap strap is worn low down, so that the pelvis is firmly engaged.
- 12.DO NOT leave this child restraint unbelted or unsecured in your vehicle because unsecured child restraint can be thrown around and may injure occupants in a sharp turn,sudden stop,or collision. Remove it if not in regular use.
- Please keep in a safe place when you do not use baby car seat.
- 13.Child should not be left in the child restraint system unattended.
- 14.NEVER use a second-hand child restraint or a child restraint whose history you do not know because they may have structural damage that endangers your child's safety.
- 15.Please keep this child restraint away from sunlight,otherwise it may be too hot for the child's skin.
- 16.A product without a certification or a modified product is dangerous, and it is also dangerous to not have the installation instructions provided by the manufacturer.
- Please install the seat according to the installation method given in this manual.
- 17.DO NOT use this child restraint as a regular chair as it tends to fall down and injure the child.
- 18.Do NOT try to disassemble the parts of the baby car seat or to change the binding mode of the safety seat's straps, except there is a description in the manual.
- 19.Do not use the baby seat if the adult seat belt interferes with the main force bearing point of the child's seat. If you have any questions about this, please contact the baby car seat's manufacturer.

20.A baby car seat is prohibited in a foldable car seat without locking correctly, an emergency brake without a lock on the back of the seat may invalidate the baby car seat.

21.The child restraint shall not be used without the soft goods.

22.The soft goods should not be replaced with any other than the one recommended by the manufacturer, because the soft goods constitutes an integral part of the restraint performance.

23.DO NOT put anything other than the recommended inner cushions in this child restraint.

It is forbidden to put something under baby car seat to raise the height of baby car seat—because the baby car seat may be invalidated in an accident.

24.DO NOT carry this child restraint with a child in it.

25.Any luggage or other objects liable to cause injuries in the event of a collision shall be properly secured.

26.Do not allow the child restraint harness or buckles to become trapped or caught in the vehicle seat or door.

27.Remove this child restraint from the vehicle seat when it is not in use for a long period of time.

28.If the child has accidentally unfastened the car belt or harness system, please park the car in a safe place and refasten before continue driving.

29.To avoid suffocation, remove plastic bag and packaging materials before using this product. The plastic bag and packaging materials should then be kept away from babies and children.

30.Consult the distributor for issues concerning maintenance, repair and part replacement.

31.DO NOT use any load bearing contact points other than those described in the instructions and marked in the child restraint.

32.Frequently check the ISOFIX attachments guides for dirt and clean them if necessary.

33.Do not place the child restraint in seating positions where an active frontal airbag is installed if your child is still in rear facing mode.

34.The device should be changed when it has been subject to violent stresses in an accident.

35.DO NOT make any modification to this child restraint or use it along with component parts from other manufacturers.

36.NEVER use ropes or any other substitutes in place of seat belts in case of injuries from restraint.

37.If the child has accidentally unfastened the seat belt in the car, please park the car in a safe place and refasten the seat belt and continue driving.

38.Please teach your child the correct concept of safety, lead by example, and put on a seat belt. Do not violate the safety principle by crying children.

39.The rigid items and plastic parts of a child restraint must be so located and installed that they are not liable, during everyday use of the vehicle, to become trapped by a movable seat or in a door of the vehicle

Parts List

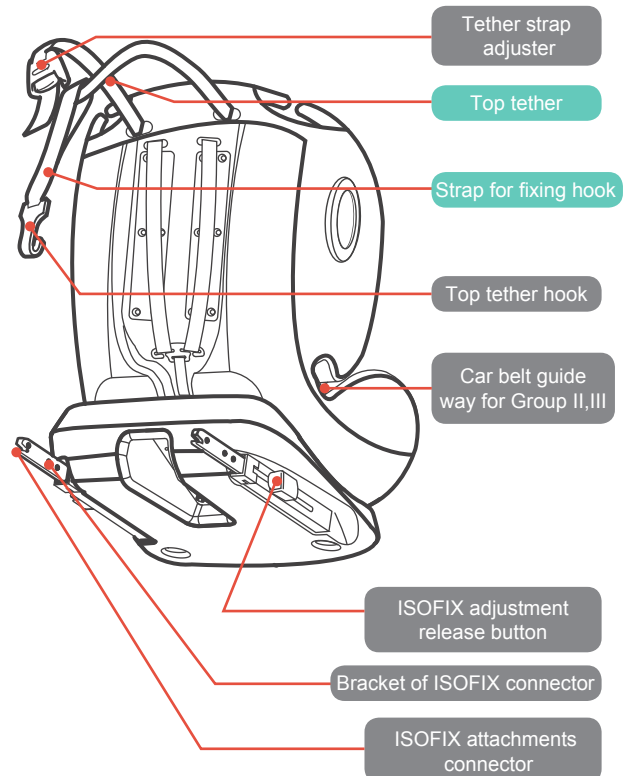
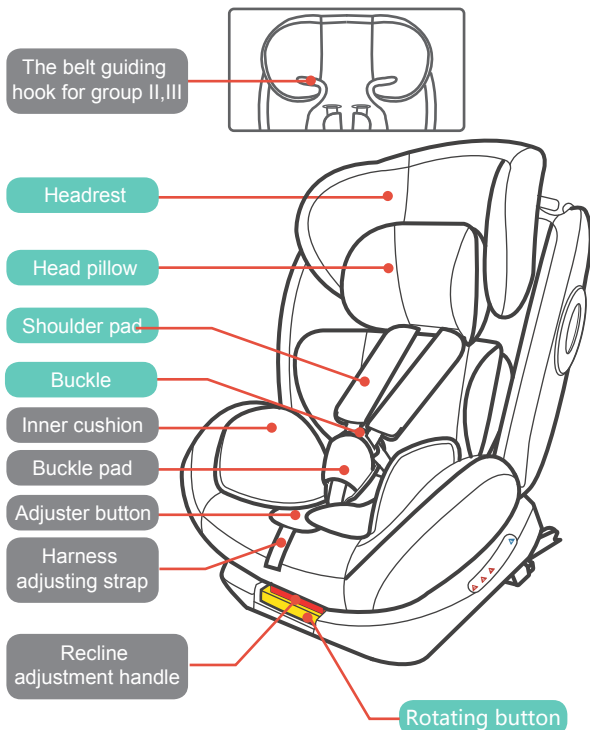

Take care of all spare part, any lost make sure to contact with manufacturer, The parts lack of damaged baby car seats are not allowed to use.

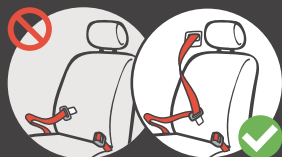

Do not install this child restraint under the following conditions:

1. Vehicle seats with 2-point safety belts.
2. Vehicle seats facing sideward or rearward with respect to the running direction of the vehicle.
3. Vehicle seats unstable during installation.

The applicable car model must be equipped with the safety belt of the 3-point belt retainer required by GB14166 or ECE R16.

The suitable location for installation on the car is shown on the left:



 Do not place the child restraint in this vehicle seat where an active frontal airbag is installed if your child is still in rear facing mode.

 Best seat to place child restraint.

 Do not place the child restraint in the vehicle seat with 2-point safety belts.

Installation method (based on your child's weight)

This baby car seat has four mass group based on (GB27887-2011) and (ECE R44/04), Please choose the way to install the mass group corresponding to the children's immediate weight .



0+

<13 kg

New born to 18 months



P14



P10, P11



I

9-18 kg

9 months to 4 years old



P16



P10, P12



II

15-25 kg

3 to 6 years old



P20



P10, P20



III

22-36 kg

5 to 12 years old



P20



P10, P20

Installation way selection of Group 0+,I

Group 0+

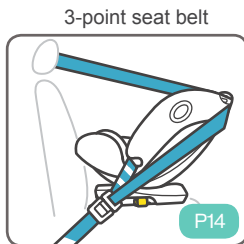
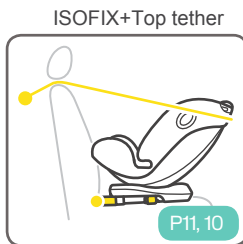

Group I

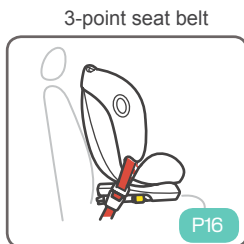

- Group 0+, there are 3 fixed point when use ISOFIX, Do not forget any one.
- Group I II III, ISOFIT is allowed to use as bottom fixed point.

How to install ISOFIX

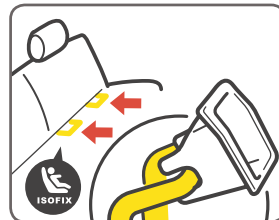

Fit the ISOFIX attachments guides with the ISOFIX attachments anchor points.

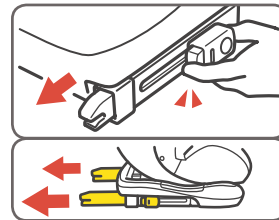

Extend the ISOFIX attachments connectors by depressing on the release button. Adjust the right length of the ISOFIX connector.

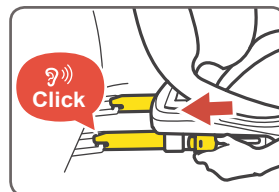

Make sure that both ISOFIX attachments connectors are securely attached to their ISOFIX attachments anchor points.

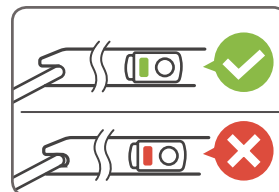

The colors of the indicators on both ISOFIX attachments connectors should be completely green.

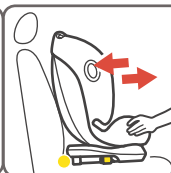
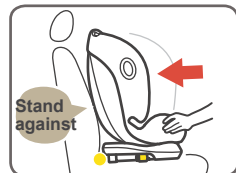

Push backrest of baby car seat to car seat tightly, make the length of ISOFIX to the shortest, then check by moving child seat back and forth if the baby car seat is fastness.

Group 0+ Installation with ISOFIX and top tether.

Group 0+

Suitable for

0-13 kg

children weighing
(New born to 18 months)

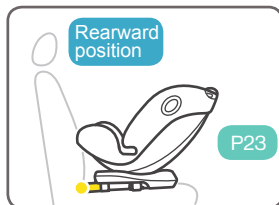

Press the rotating button to rotate the seat to rearward direction.

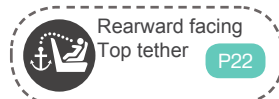

Adjust top tether to rearward state and suitable length.

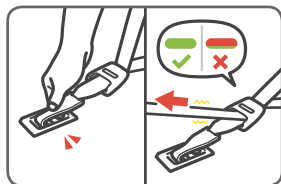

Connect the tether hook securely to the anchorage fitting. The colors of the indicators on tethers strap adjuster should be completely green.

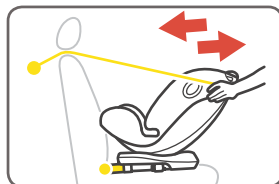

Check by moving child seat back and forth if the baby car seat is fastness.

Group I forward facing (Installation with ISOFIX and seat belt)

Group I

Suitable for

9-18 kg

children weighing
(9 months to 4 years old)

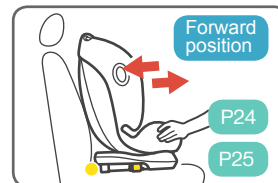

Rotate the seat to forward direction. Make sure that both ISOFIX attachments connectors

are securely attached to their ISOFIX attachments anchor points tightly.

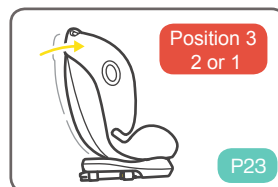

Recline level adjust to level 3 2 or 1.



Remove all inner pad when child is one and a half years old.



Pull out the seat belt entirely.

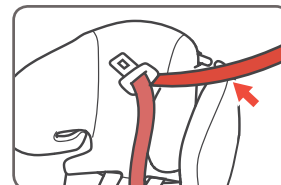

Pass the shoulder strap of the car seat belt through the seat belt guide hook.



Fasten car seat belt and ensure that the shoulder strap and the belly strap pass through the guide manager at the bottom.

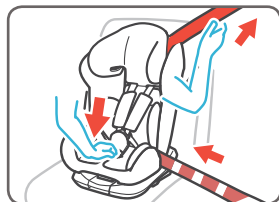

Hold down the child seat by one hand, pull the belt tightly by another hand



Special notes: Make sure the child seat is fixed tightly before using.
Using ISOFIX together with car belt can enhance the security.
DO NOT USE ISOFIX ALONE.

Group 0+ installation with car belt only

Group 0+

Suitable for

0-13 kg

children weighing
(New born to 18 months)

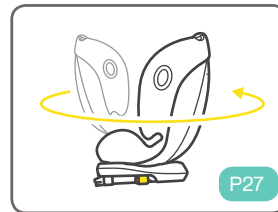

Rotate the seat to rearward direction.

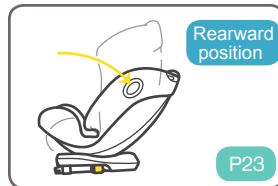

Recline the seat to position '4'.



Put the child seat on installation position with rearward facing.

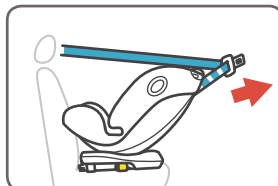

Pull out the seat belt entirely.

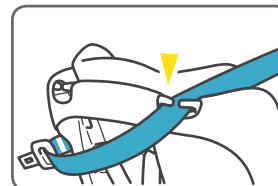

Pass the seat belt through the seat as shown.

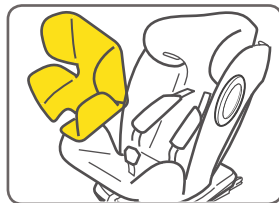

Unlock the harness and lift up the inner cushion.

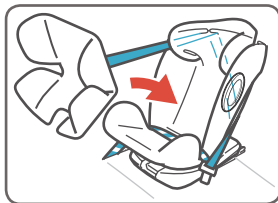

Pass the seat belt through the seat as shown, put the inner cushion back.



Fasten the belt.

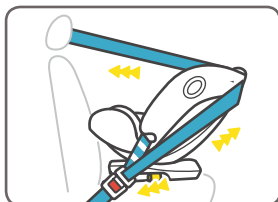

Pull the belt tightly.

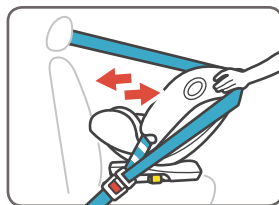

Please check by moving the child seat back and forth to make sure every strap is tightly.



Tips: Before using the safety seat, make sure the safety seat is firmly installed. The webbing is not twisted.

Group I forward facing (installation with seat belt)

Group I

Suitable for

9-18 kg

children weighing
(9 months to 4 years old)

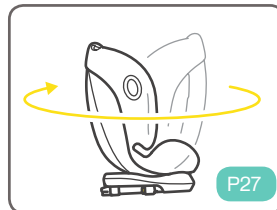

Rotate the seat to forward direction



Recline level adjust to level 3 2 or 1.



Remove all inner pad when child is one and a half years old.



Place child safety seat in car.



Pull out the seat belt entirely.

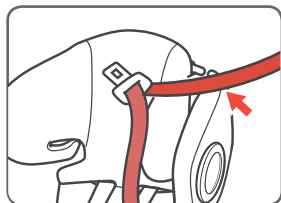

Pass the shoulder strap of the car seat belt through the seat belt guide hook.



Fasten car seat belt and ensure that the shoulder strap and the belly strap pass through the guide manager at the bottom.

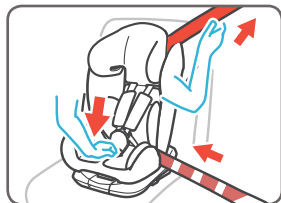

Hold down the child seat by one hand, pull the belt tightly by another hand

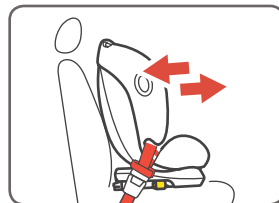

Please check by moving the child seat back and forth to make sure every strap is tightly.



Tips: Before using the safety seat, make sure the safety seat is firmly installed. The webbing is not twisted.

Group 0+I (Using 5 point harness to fix child)

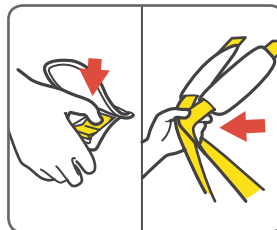

While pressing the harness adjustment button, pull completely the two shoulder harnesses of the child restraint.

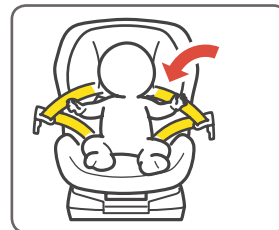

Place the child in the child restraint and pass both arms through the harnesses.

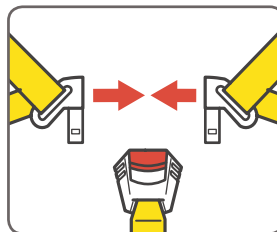

Important: The left and right bolts of the 5-point safety seat buckle are combined first.

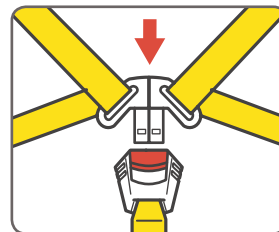

Engage the buckle as pitures show.



One side of 5-point safety seat buckle was locked is not allowed.

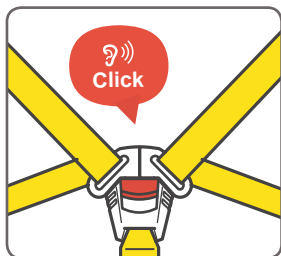

Make sure the buckle is properly engaged.

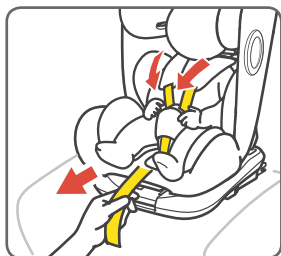

Pull the retractor belt to the right tightness.

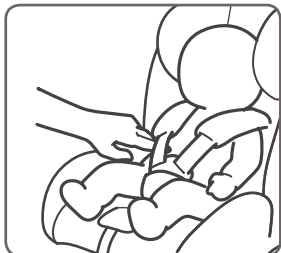

Make sure the space between the child and the shoulder harness is about the thickness of two fingers.

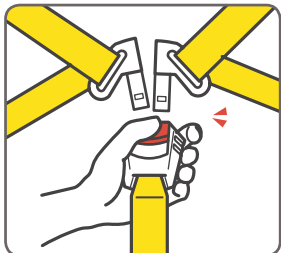

Press the red button to disengage the buckle.

The style of the buckle may vary, depending on the actual receipt.



Warning:
Over-relaxed seat belts are not conducive to protecting children's safety.

Group II Group III (Installation with seat belt)

Group II
Group III

Suitable for
15-36 kg
children weighing
(3 to 12 years old)

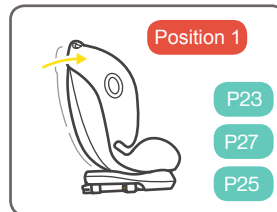

Rotate the seat to forward direction, transfer to group II/III

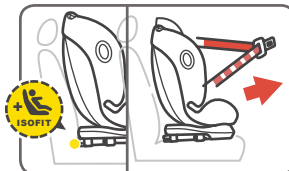

pull out the seat belt entirely
(can install together with
ISOFIX)



Shoulder belt must pass
through shoulder belt guide.
Waist belt must pass through
lap belt guidings.

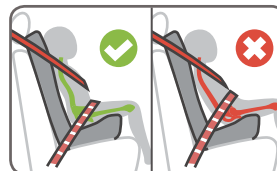
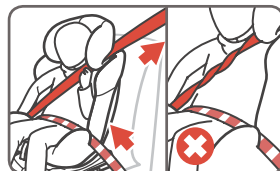

When installing and adjusting the safety belts, make sure that both the shoulder belt and waist belt are not twisted and will not keep the safety belts from being properly positioned. Note the correct belt position should be above the child's pelvis.

Release ISOFIX

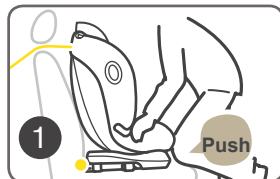

Prop up baby car seat with your knees.

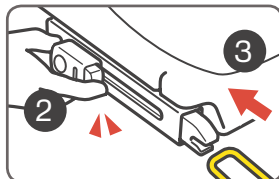

Pressing on release button and pull back to release the ISOFIX connector.

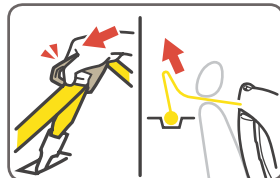

Press the button on top tether adjustment, pull out the belt to relax the top.

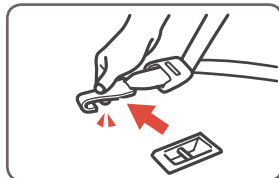

Hold down spring, remove the fixing hooks drawstrings.



Keep ISOFIX attachments guides, please store it properly.

Warning

NEVER install the product with car belt only. Please check the blue part in this page if you are failure to unblock the ISOFIX.

Not brutal demolition
Avoid damage to parts

To fix top tether correctly at rearward installation

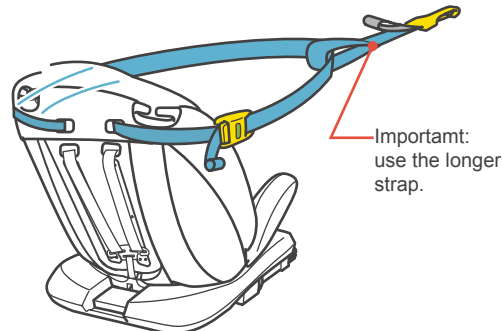

(Use the top tether correctly, avoid twisting the belt, install the fixed hook with open side down.)

► Adjustment: about the shorter top tether

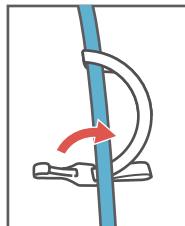

Overturn the top tether hook from the top tether's underpart to upper part.

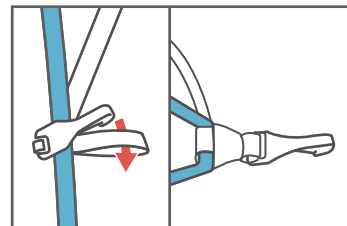

pass the top tether hook through the short strap, and tighten up.

▷ Recline adjustment

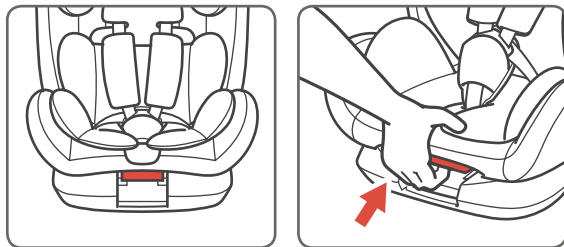

Find the red hand lever, pull it up to adjust the position.

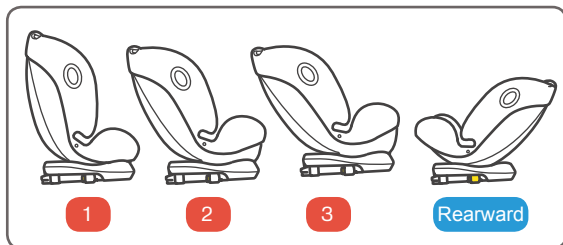

This safety seat has 3 positions for forward installation. Group I could use position 1, position 2 and position 3. Group II, III only could use position 1. The safety seat only provides one position for rearward installation.



Please use "blue" position for rearward installation. Only the correct angle can maximally protect the new born's spine.

▷ 5 point harness adjustment

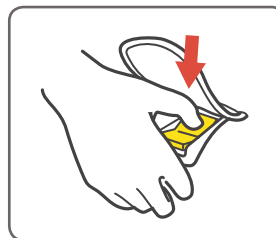

Adjusting the harness according to the current situation of child, make sure there is no twisting.

Pass the harness adjustment button



To loosen

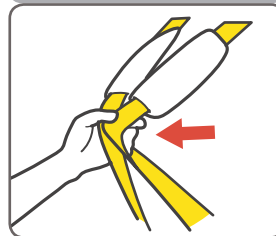

While pressing the harness adjustment button, pull completely the two shoulder harnesses of child restraint.

To tighten

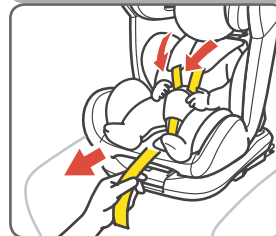

Pull down the adjustment webbing and adjust it to the proper length to make sure your child is snugly secured.

Head rest adjustment

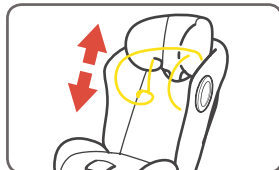

Pull the head support adjustment, meanwhile pull up or push down the head support.

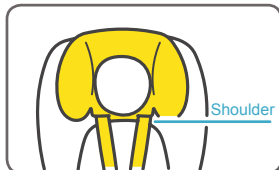

IMPORTANT :

Make sure the height is right. Group 0+, I, the shoulder harness height must be even or a little higher than with child's shoulder.

Group II, III, The belt guiding hook for group II, group III must be higher than child shoulder.

Conceal the harness system (change to Group II, III)

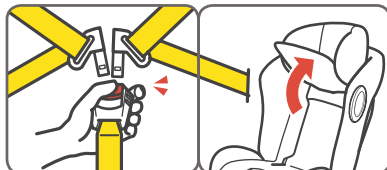

Release the 5 - point buckle, pull up the headrest, turn up the back cushion.

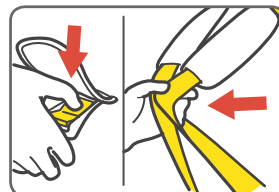

Press the harness adjustment button and loosen the straps.

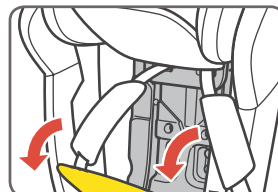

Lift the upper flap upward and pull the lower flap forward.

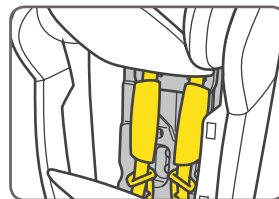

Store the shoulder harnesses and buckle in their storage compartments.

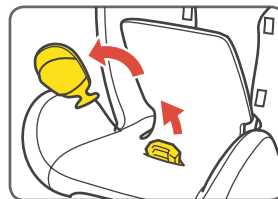

Lift up cover of bottom, remove the buckle cover, remove the lock of buckle.

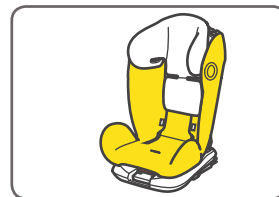

Do reattach the snaps to recover the seat pad. The reassembled seat pad is shown as above picture.

Rotate/changing direction

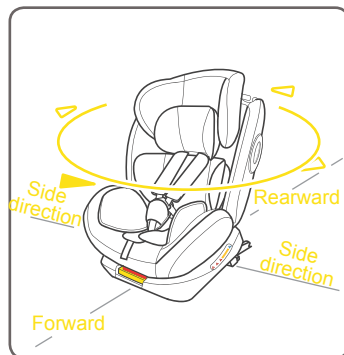

The car seat is with 360 degree rotating base which could be fixed with 4 direction.

Warning

Never use any unblock direction, fixed direction before using.

1 Rearward facing 2 Forward facing 3 4 Side facing



Suitable for group 0+

Suitable for group I II III. **group 0+ is not allowed.**

This position is only for you to place baby. **stop using this position when your car is moving.**

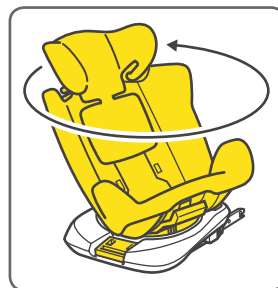
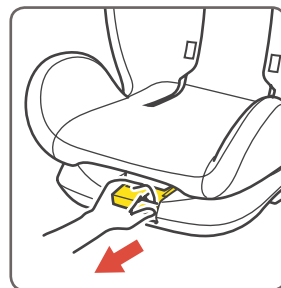

Squeeze the rotating button while rotating the seat.

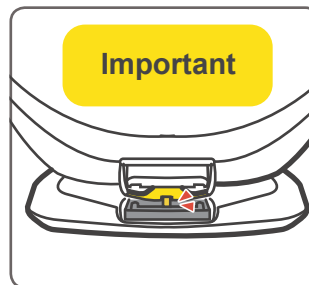

Beckrest could be locked at 4 postions(0°,90°,180°,360°) at rotating time, sound“Ka” shows backrest was locked well.

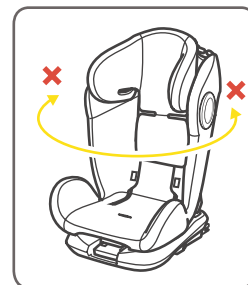

Shake backrest left and right to confirm locked.

Detach soft goods



press the red button to disengage the buckle.



Raise the back cushion under the headrest.

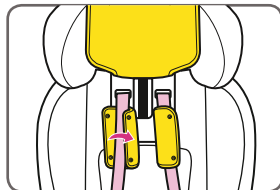

Remove the diagonal belt covers of both sides.

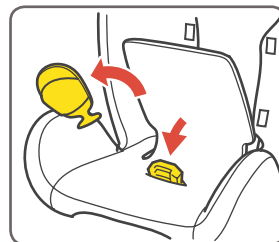
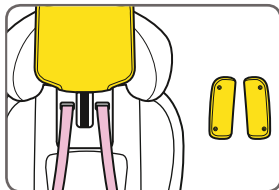

Remove the buckle pad, conceal the buckle in the buckle hole on the seat base.

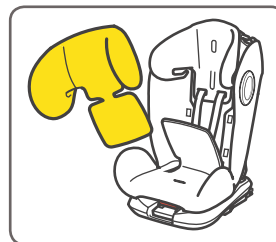

Remove the headrest cloth cover.



Remove the cloth cover all seats.

Seat cloth cover mounted:
To assemble soft goods ,reverse the steps above.

Warning

Child restraint system (safety seat) without cloth cover cannot be used.

Maintenance

Safety seat maintenance

After removing foam of infant insert, please store it somewhere that the child can not access it.

-Please wash the soft goods with cold water under 30°C.

-Do not iron the soft goods.

-Do not bleach or dry clean the soft goods.

-Do not use undiluted neutral detergent, gasoline or other organic solvent to wash the child restraint. It may cause damage to child restraint.

-Do not twist the goods to dry with great force, it may leave the soft goods with wrinkles.

-Please hang dry the soft goods in the shade.



Warning

Child restraint system (safety seat) without cloth cover cannot be used.

Safety seats save.

Please always check the seat parts are complete, the seat is in good condition to reduce the chance of accidents.

Please remove the child restraint from the vehicle seat if not in use for a long period time. Put the child restraint in the shade and somewhere your child can not access it.

Please do not leave the seat in a cold or hot, humid environment for long periods of time.

Please keep this instruction well for checking.

Post-accident treatment

In the event of a violent collision and accident, please replace it with a new seat. If you have any other questions, please contact the distributor or manufacturer.

Dimension info

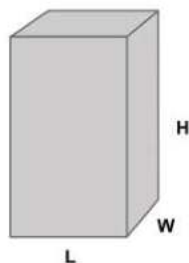

LENGTH	38 CM	CARTON LENGTH	46.5 CM
WIDTH	46 CM	CARTON WIDTH	46.5 CM
HEIGHT	81 CM	CARTON HEIGHT	76.5 CM

WEIGHT	8.3 KGS
--------	---------

Note
