

BEBECOO

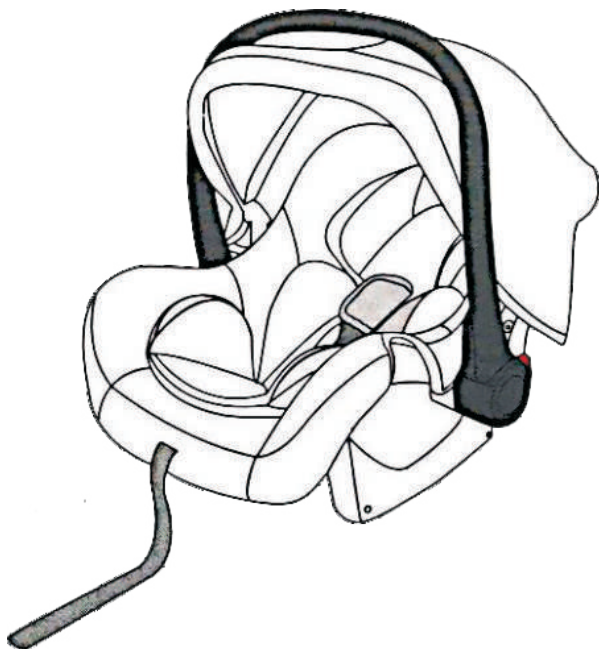

BEE CAR SEAT INSTRUCTION MANUAL

Group0+ (0-13kg) suitable from birth up to 13kgs

Congratulations on your purchase of the INFANT SEAT

This product has been designed and developed with safety, comfort and functionality in mind. Please take the time to read this manual carefully before using this product and keep it in a safe place for future reference.

NOTICE

- 1.This is a “Universal” child restraint; it is approved to Regulation No. 44,04 series of amendments, for general use in vehicles and it will fit most ,but not all, car seats.
- 2.A correct fit is likely if the vehicle manufacturer has declared in the vehicle handbook that the vehicle is capable of accepting a “Universal” child restraint for this age group.
- 3.This child restraint has been classified as“Universal” under more stringent conditions than those which applied to earlier designs which do not carry this notice.
- 4.If in doubt, consult either the child restraint manufacturer or the retailer.

Only suitable if the approved vehicles are fitted with 3-point safety-belts, approved to UN/ECE Regulation No.16 or other equivalent Standards.

EXTREME HAZARD

Do not use in passenger seats equipped with airbags (SRS)

Please read through these instructions carefully before using the infant seat for first time. The instructions can be retained on the infant seat for its life period.

Applicability:

The infant seat is suitable for weight categories 0+.



Group 0+: less than 13kg

WARNING

DO NOT use this rearward facing restraint in seating positions where an active frontal airbag is installed.

Your child seat can only be installed rearward facing (in the direction opposite the one in which you are travelling) with a 3 point safety harness.



Correct fitting/suitable



Incorrect fitting/not suitable

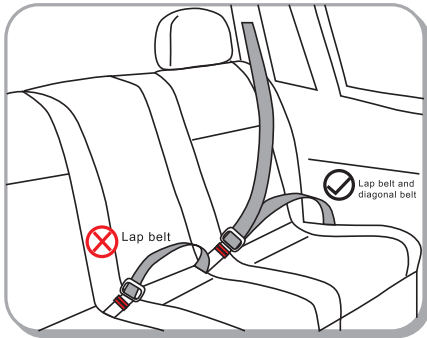

This child seat is suitable for conventional use in all cars equipped with 3-point seat belts that are fitted in accordance with European standard (ECE44 or equivalent standard)

Important:

This child seat must only be installed using a lap and diagonal seat belt.

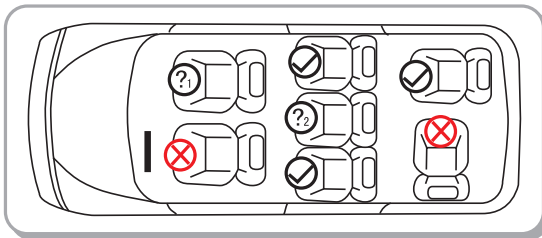

Not to be used on this seat if a passenger front airbag is active.



Only use on this seat if a lap and diagonal seat belt is fitted.

SAFETY WARNINGS



Please read this user guide carefully before install the child seat and for future reference.

- The instruction can be retrained on the child restraint for its life period .
- This child restraint must be used with the harness for children of less than 13kg in weight ,and heights less than 26 inches (66cm).
- This child restraint can only be installed rearward facing using a three-point lap and diagonal seat belt.
- Only suitable if the approve vehicles are fitted a 3-point safety belts with retractor, approved to UN/ECE Regulation No.16 or other equivalent Standards.
- Rigid items and plastic parts of a child restraint system must be likely located and installed so that they are not liable, during everyday use of the vehicle, to become trapped by a moveable seat or in a door of the vehicle.
- This rear-facing child restraint system can not be used in seating position where there is an airbag enabled.
- This “Special Needs Restraint” is designed to give extra support to children who have difficulty in sitting correctly in conventional seats. Always consult your doctor to make sure that this restraint system is suitable for your child.
- Ensure that the strap, holding the restraint to the vehicle, are as tight as possible. Make sure that the straps ,restrain the child at the correct height and are not twisted.
- In an event of an accident, the child restraint system **MUST BE REPLACED**.
- For maximum protection, the center rear seat position is recommended for the safest position in most vehicles for installing a child restraint. Only when the seat is provided with a 3-point adult belt.
- Your child restraint should not be purchased or sold as a second hand item.It is not recommended to use child restraint older than 6 years old as the protection in an accident may be reduced.
- This safest seating position for this child car seat is on the rear seat of a vehicle.
- It is dangerous to make any alterations or additions to the device without the approval of the competent authority , and a danger of not following closely the installation instructions provided by the child restraint manufacturer .
- Do not leave your child unattended in the seat at any time .
- Never use the child seat without fastening the child in it and without fastening it into the car.
- The seat should be kept away from sunlight if the seat is not provided with a textile cover, otherwise it may be too hot for the child's skin.
- In the event of an emergency it is important that the child can be released quickly .This means that the buckle is not fully tamper proof and so your child must be taught never to play with the buckle.

- Any luggage or other objects liable to cause injuries in the event of a collision shall be properly secured.
- Never use the seat as a shopping bag or as a means for transporting sometime.
- The child restraint can not be used without the cover. The seat cover should not be replaced with any other than the one recommended by the manufacturer, because the cover constitutes an integral part of the restraint performance.
- Periodically inspect the harness for wear , paying particular attention to attachment points . stitching and adjusting devices.
- Ensuring that any lap straps is worn low down , so that the pelvis is firmly engaged, shall be stressed.
- The seat device should be changed when it has been subject to violent stresses in an accident.
- Do not use any load bearing contact points other than those described in the instructions and marked in the child restraint.

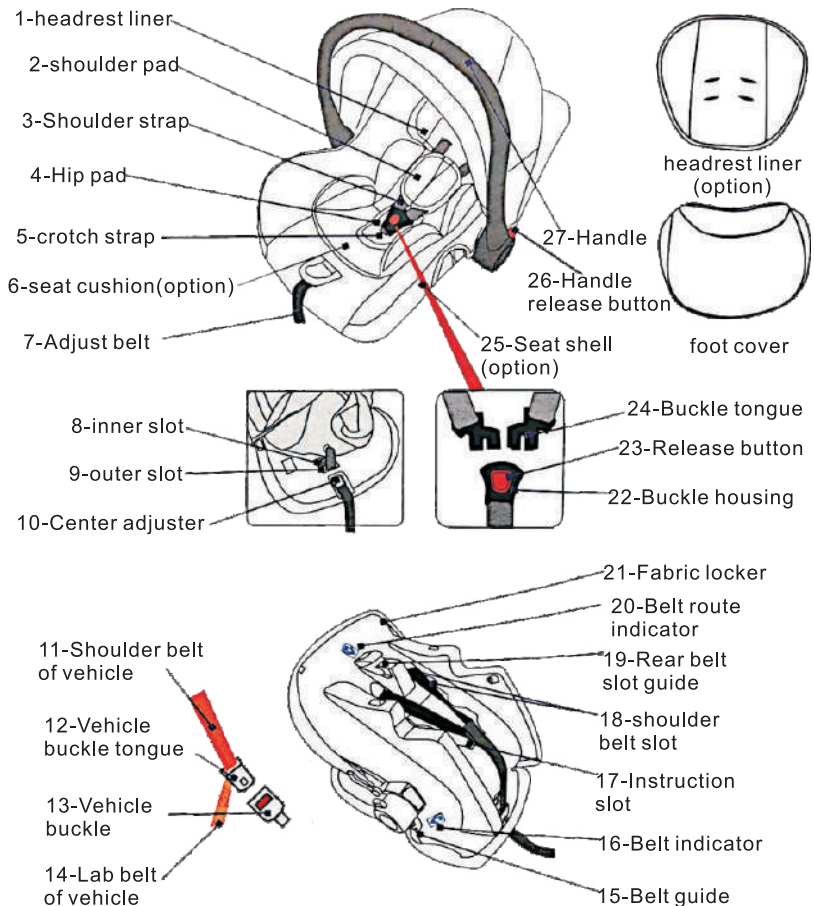

Tighten the shoulder harness

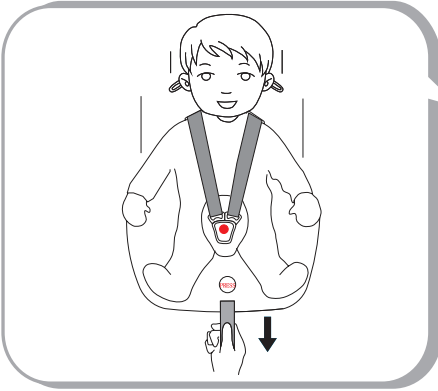

Pull the shoulder straps upwards to remove the whole harness then pull the adjuster strap until the harness is fully tightened.

To release the harness (see point AD JUSTING THE SHOULDER HEIGHT), press the red button on the buckle downwards.

The harness should be adjusted as tightly as possible without causing discomfort to your child.

SECURING THE INFANT CARRIER

Please read the operating handbook in your vehicle to inform yourself about the basics concerning children's seat in vehicle .

DO NOT place this baby seat on seat with front airbags.

This baby car seat can only be installed using a three-point vehicle belt.

The baby car seat must be installed rearwards facing (in the direction opposite the one in which you are traveling) .



Step 1: Adjust the handle to the upright position .Place the child safety seat on the vehicle's seat ensuring it is firmly pressed against the car seat backrest.

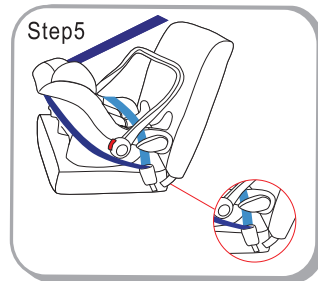
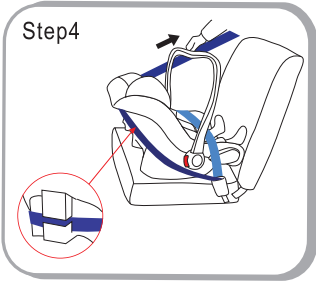
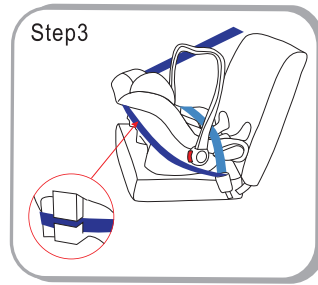
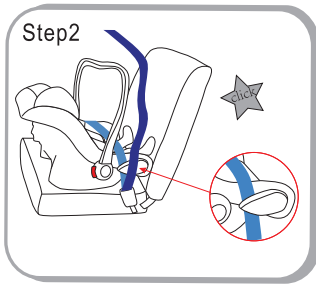

Step2. Slide the lap belt of the vehicle's 3-point seatbelt through both Lap belt guides .Let the tongue plate snap in the belt lock with a clearly audible "click".Pull the shoulder belt in arrow direction to tighten the lap belt.Check to make sure the tongue plate is locked by pulling on the belt .

Step3.Place the diagonal belt in thediagonal belt guide at the back of the seat

Step4.Tighten the vehicle's own 3-pointseatbelt by pulling hard on the positions .

Step 5 : Adjust the handle to the forward position .Place the child safety seat on the vehicle's seat ensuring its handle must be firmly against the car seat backrest.

The satisfactory position of the adult safety-belt buckle relative to the child car seat is as the following picture. You can contact the child car seat manufacturer if in doubt about this point.

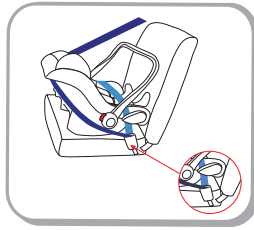

Make sure all the belts` position is right and they has not become twisted. Also check that the cover is not impeding the movement or fit of the belt webbing in any way.

To release your baby car seat following the above instructions in reverse order.

ADJUST THE HANDLE

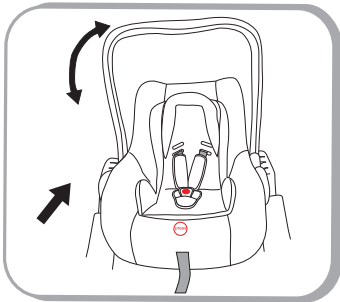

The handle for the baby car seat can be adjusted into 4 stable positions. To adjust the handle ,please press the red button of handle on both sides at the same time .Now it can be adjusted.

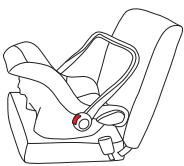

①

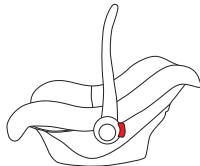

②

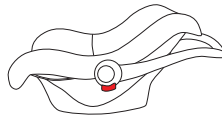

③

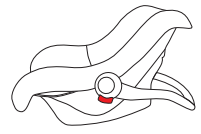

④

The carry handle has four positions:

- 1.Forward facing installed in the car .This position (only this position) is suitable for the baby car seat installed on the vehicle seat .
- 2.Straight up for carrying .
- 3.Handle clicked back to initiate the rocking feature .
- 4.Down to support baby for feeding and play .

Ensure that the handle is locked in a position ,the harness is correctly fitted and buckle fastened before carrying your car seat.

CANOPY ASSEMBLY

1. Adjust the handle to the position same as the following picture
 2. Insert frame through sleeve of canopy.
 3. Insert both ends of canopy frame into the canopy frame joint parts which locate on the both side of the car seat and above the handle.
 - 4 Fix the bottom of the canopy cover to the top of the car seat back, see the following picture.
 5. Rotate the canopy frame joint parts and the canopy will reach the proper position you want.
 6. Rotate the handle and the handle will reach the proper position you want.
- When you do not need canopy just take off it in reverse order of the above instruction.

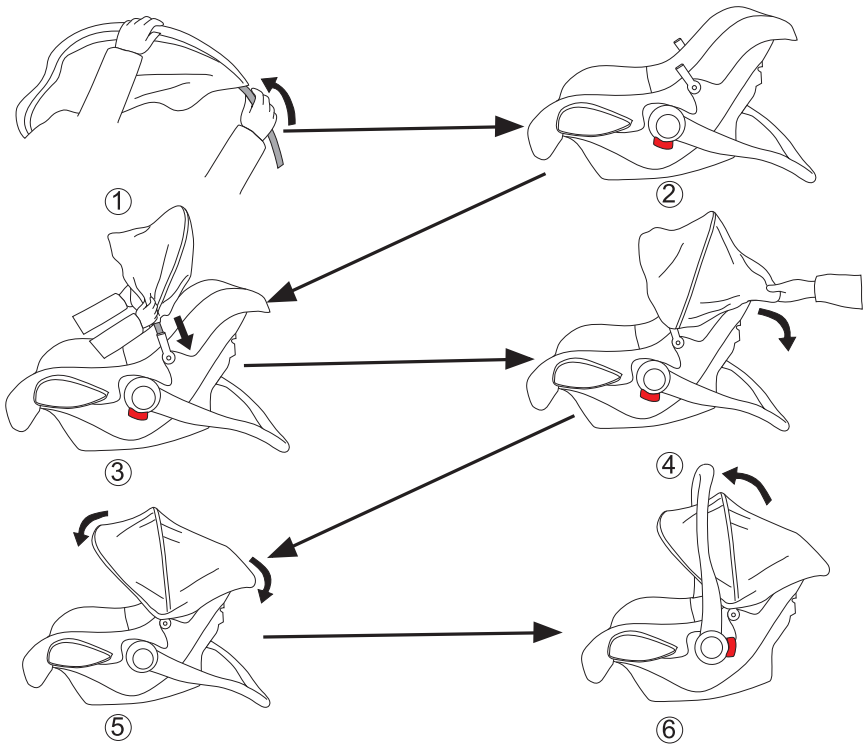

Cleaning & maintenance:

These instructions are important .Please read carefully and retain for future reference.

The child restraint can not be used without the cover.

The seat cover should not be replaced without one recommended by the manufacturer .Because the cover constitutes an integral part of the restraint performance.

Don't use any car seat again after impact or accident.





Please remove the car seat out of vehicle when it is not used and keep out reach of child.

Please always fasten the car seat when it is inside the vehicle.

Please always read the manual before use it, and the manual is locate in the back of car seat, under the cover bag.

Washing instruction:

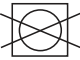
The cover is removable and washable at 30 °C ,line dry only.

				
Machine wash, cpld	Do not bleach	Dry clean, any solvent except trichloroethylene	Do not tumble dry	Do not iron

If you are in doubt about using or fitting of this product or you require any replacement parts ,please contact our customer hotline.

European safety child seat is sweeping the whole world now



European safety standard

DIMENSION INFO

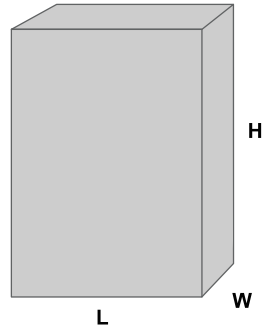

LENGTH	64 CM	CARTON LENGTH	68 CM
WIDTH	45 CM	CARTON WIDTH	43 CM
HEIGHT	57 CM	CARTON HEIGHT	88 CM

WEIGHT	2.7 KGS
---------------	----------------