



Stores: ChelinoBaby – Ormonde - JHB

ChelinoBaby – Fourways – JHB

ChelinoBaby – Menlyn – Pretoria

ChelinoBaby – Kolonnade-Pretoria

ChelinoBaby – Gateway - Durban

ChelinoBaby – Online – www.chelinobaby.co.za



Imported for :

ChelinoBaby Group of Companies

No. 12 Kimberlite Road, Theta Ext 5, Booysens Reserve,
JHB, 2091 S.A.

Tel: +27 11 8352520

Info: info@chelinoplatinum.co.za

Chelino
PLATINUM

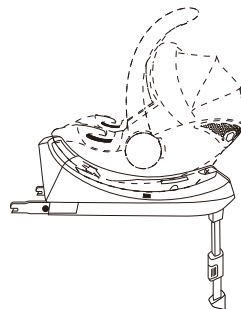

CP09 ISOFIX BASE

CHELINOBABY GROUP OF COMPANIES.

NO. 12 KIMBERLITE ROAD, THETA EXT 5, BOOYSENS RESERVE, JHB, 2091.SA.

+2711 835 2520



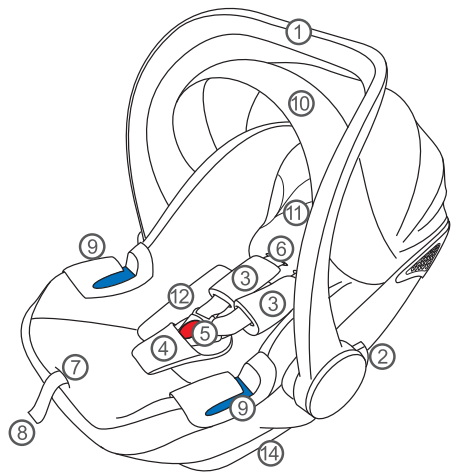

(1)

Manual Location

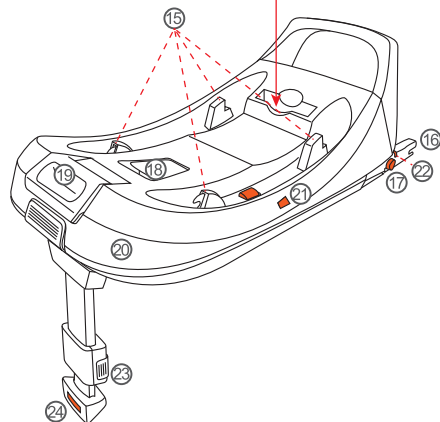

(2)

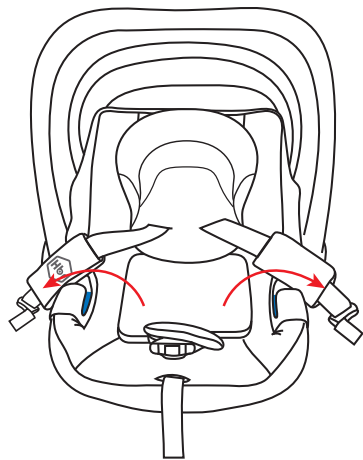

(3)

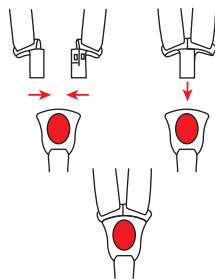

(4)

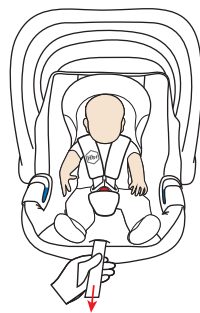

(5)

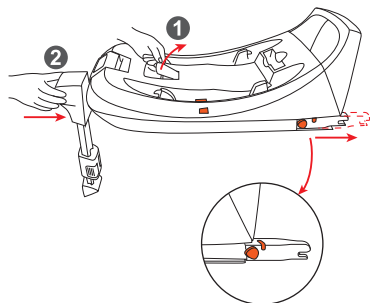

(6)

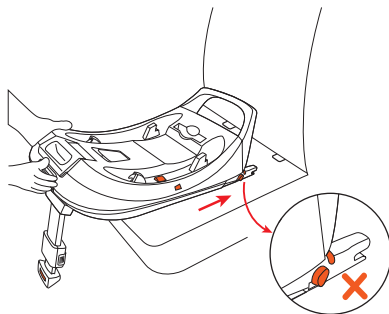

(7)

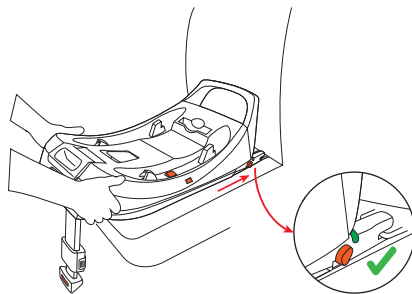

(8)

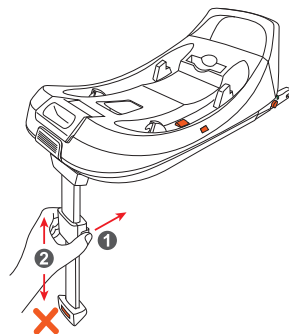

(9)

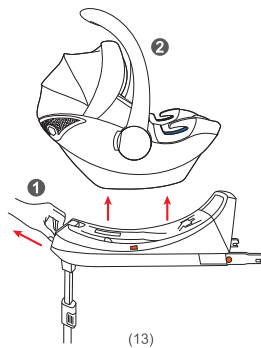
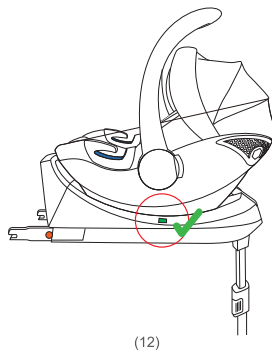
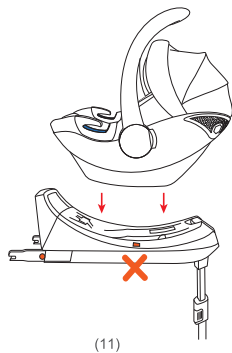
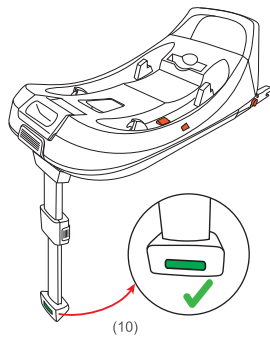

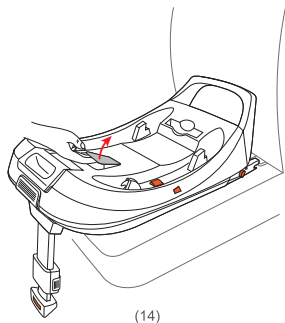

(14)

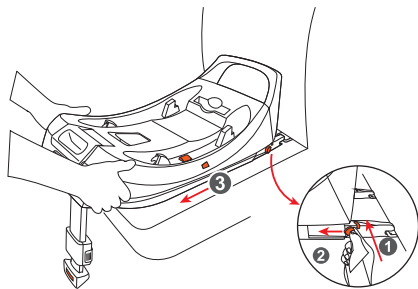

(15)

- 1、 Handle
- 2、 Handle button
- 3、 Shoulder pad
- 4、 Crotch pad
- 5、 Buckle
- 6、 Webbing
- 7、 Center function adjustment
- 8、 Adjustment webbing
- 9、 Side webbing guide
- 10、 Canopy
- 11、 Headrest
- 12、 Inner pad
- 13、 Front webbing guide
- 14、 Carrier shell

- 15、Connecting hooks
- 16、ISOFIX connector
- 17、ISOFIX release button
- 18、ISOFIX tube button
- 19、Release button of carrier from base
- 20、Base cover
- 21、Indicator window of green/orange switch for carrier installed with base
- 22、Indicator window of ISOFIX locked
- 23、Adjustment button of support leg
- 24、Indicator window of support leg worked

Installation in the car with ISOFIX base :

1、Loosen shoulder belts by pressing the adjustment button on central adjuster and simultaneously pulling both shoulder belts up. (Picture 3)

2、Put your child into the child seat, place shoulder belt directly over your child's shoulders and ensure the shoulder belts are not twisted.

Place both buckle tongues together and lock them in place in belt buckle with an audible "CLICK". (Picture 4)

Pull cautiously on central adjustment belt in order to tighten shoulder belts until they fit your baby's body. (picture 5)

3、Unfold the sun canopy by pulling gradually on the plastic cover. To fold up, push the sun canopy back to the start position.

4、Pull up the button (1) and simultaneously push the top cover of the support leg to the last position. (Picture 6)

5、Push the base to connect the car ISOFIX anchors firmly. The indicator color of the ISOFIX connector turns into green from orange. (Picture 7/8)

6、Push the base to make it be as close to the car chair's backrest as possible.

7、Push the button (1) out and move the support leg of underside simultaneously to make the end of the support leg to touch the floor of the car compartment firmly. The color of the indicator in the support leg end cover turn into green from orange. (Picture 9/10)

8、Put the carrier with baby onto the base as (picture 11)The indicator color turn into green from orange (picture 12)

Uninstallation of the carrier and base

1、 Pull the button(1) in and pull up the carrier from the base simultaneously to release the carrier from the base. (Picture 13)

2、 Pull up the button as picture 14

3、 Press the orange button as the red arrow 1 direction simultaneously and pull the button as red arrow 2 direction to release the two ISOFIX connectors from the vehicle anchors as picture 15

Cleaning

The cover and the belt can be cleaned with a clean cloth and some lukewarm soapy water. The plastic parts can be cleaned with a mild detergent and warm water.

Remark :

Due to variation on the styles and designs of our products, the photographs and illustrations shown in this manual are generic. Therefore products fabric, colour and design may vary from images shown, Chelino reserves the right to alter products specifications.

Dimension Info



| | | | |
|--------------------|-------|----------------------------------|--------|
| ISOFIX BASE LENGTH | 76 CM | CAR SEAT WITH ISOFIX BASE LENGTH | 70 CM |
| ISOFIX BASE WIDTH | 34 CM | CAR SEAT WITH ISOFIX BASE WIDTH | 45 CM |
| ISOFIX BASE HEIGHT | 75 CM | CAR SEAT WITH ISOFIX BASE HEIGHT | 100 CM |
| ISOFIX BASE WEIGHT | 6 KGS | | 11 KGS |

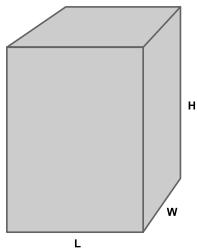

| | |
|---------------|---------|
| CARTON LENGTH | 34.5 CM |
| CARTON WIDTH | 22 CM |
| CARTON HEIGHT | 75.5 CM |

Note

This image shows a single sheet of white paper with horizontal blue or grey ruling lines. The lines are evenly spaced and run across the width of the page. There are approximately 20 lines visible. The paper appears to be a standard notebook page or a sheet of stationery.

Note

[illegible]

Note

[illegible]