

# ChelinoBaby®

Stores: ChelinoBaby – Ormonde – JHB  
ChelinoBaby – Fourways – JHB  
ChelinoBaby – Woodmead Square – JHB  
ChelinoBaby – Greenstone – JHB  
ChelinoBaby – Centurion – Pretoria  
ChelinoBaby – Menlyn – Pretoria  
ChelinoBaby – Kolonnade – Pretoria  
ChelinoBaby – Gateway – Durban  
ChelinoBaby – Cavendish Square – Cape Town  
ChelinoBaby – Nelspruit – Mpumalanga  
ChelinoBaby – Online – [www.chelinobaby.co.za](http://www.chelinobaby.co.za)



Imported for :  
Chelino Baby Group of Companies.  
No. 12 Kimberlite Road , Theta Ext 5 ,  
Booyens Reserve , JHB , 2091. SA.  
Tel: +2711 8352520  
Info: [info@chelino.co.za](mailto:info@chelino.co.za)

# Chelino

## TIFFANY 2 IN 1- COT/CO SLEEPER INSTRUCTION MANUAL



ChelinoBaby Group of Companies.  
No. 12 Kimberlite Road , Theta Ext 5 ,  
Booyens Reserve , JHB , 2091. SA.  
+2711 835 2520  
[www.chelinobaby.co.za](http://www.chelinobaby.co.za)



# WARNINGS

- DO NOT LEAVE YOUR CHILD UNATTENDED IN THE CAMP COT.
- THIS PRODUCT WAS DESIGNED TO BE USED BY ONLY ONE CHILD AT A TIME. DO NOT PLACE MORE THAN ONE CHILD IN THIS PRODUCT AT ANYTIME.
- ENSURE YOUR CHILD OR ANY OTHER PERSON/CHILD IS CLEAR OF ANY MOVING PARTS WHILST ADJUSTING THE PRODUCT TO SUIT YOUR REQUIREMENTS.
- DO NOT USE ANY ACCESSORY OTHER THAN THOSE APPROVED BY CHELINO.
- DO NOT USE THE CAMP COT WHEN YOUR CHILD REACHES 89CM IN HEIGHT, WEIGHS MORE THAN 14KG OR IS ABLE TO CLIMB OUT.
- TO PREVENT FALLS, DO NOT USE BASSINET, CARRY COT AND DIAPER CHANGER WHEN INFANT BEGINS TO PUSH UP ON HANDS AND KNEES OR WEIGHS OVER 6.8KG, WHICHEVER COMES FIRST.
- NEVER USE ADDITIONAL MATTRESS, PADDING, SHEETS, OR OTHER OBJECTS THAT WILL PERMIT YOUR CHILD TO CLIMB OUT, FALL OR BE INJURED.
- NEVER LEAVE DIAPER CHANGER IN PLACE WHEN CHILD IS IN THE CAMP COT.
- NEVER LEAVE CARRY COT IN PLACE WHEN CHILD IS IN THE CAMP COT.
- DO NOT SUSPEND STRINGS INTO THE CARRY COT, BASSINET OR CAMP COT.

# IMPORTANT NOTES

- DUE TO VARIATION ON THE STYLES AND DESIGNS OF OUR PRODUCTS, THE PHOTOGRAPHS AND ILLUSTRATIONS SHOWN IN THIS MANUAL ARE GENERIC. THEREFORE PRODUCTS FABRIC, COLOUR AND DESIGN MAY VARY FROM IMAGES SHOWN, **CHELINO** RESERVES THE RIGHT TO ALTER PRODUCTS SPECIFICATIONS.
- ALWAYS FOLLOW THE INSTRUCTION MANUALS. READ ALL INSTRUCTIONS CAREFULLY BEFORE ASSEMBLY AND USE OF THIS PRODUCTS.
- ALWAYS USE THIS PRODUCT ON A EVEN AND LEVEL SURFACE.
- ALWAYS REMOVE THE CHILD WHEN MOVING/ADJUSTING THE PRODUCT.
- DO NOT LIFT THE PRODUCT UP WHILST THE CHILD IS INSIDE.
- DO NOT ALLOW CHILDREN TO STAND IN THIS PRODUCT.
- DO NOT HANG ANYTHING OVER THE RAILS OF THIS PRODUCT.
- DO NOT EXPOSE THE PRODUCT TO ANY OPEN FLAME / HEATING DEVICE / CORDS OR CURTAINS WHICH CAN CAUSE INJURY OF YOUR CHILD.
- NEVER USE THIS PRODUCT IF THERE ARE ANY LOOSE OR MISSING PARTS, LOOSE JOINTS, BROKEN PARTS, OR TORN MESH/FABRIC.

## PARTS LIST



A.Camp Cot Frame

A



B.Mattress

B



C.Bassinet

C



D.Daybed

D



E.Nappy Changer

E



F.Second Layer Tube

F



G.Mosquito Net

G



H.Safety Belt

H



I.Toys

I



J.Music Box

J



K.Carry Bag



L.Straps for mattress

## 1.ASSEMBLING THE CAMP COT:

- 1.Unzip the bag and remove the camp cot from the bag.
- 2.Carefully place all loose parts on the floor.
- 3.Unpeel the 2 Velcro straps and unwrap the mattress.
- 4.Remove all loose parts and set aside.
- 5.Ensure the center base is up and not pushed down whilst erecting the cot.
6. Lift the short sides of the camp cot and make sure the four sides are close to the horizontal .(Fig.B)
- 7.Thereafter push the center base of the camp cot down until it lock into position.
- 8.The cot will now be fully erected, the four sides will be locked into position and the center base will be locked as well.
- 9.Open the plastic bag and take out the mattress .Then place the mattress on the bottom.





## 2. INSTALLING THE BASSINET:

1. Zip the bassinet on and cover the zipper with the zipper cover to avoid baby from getting injured.

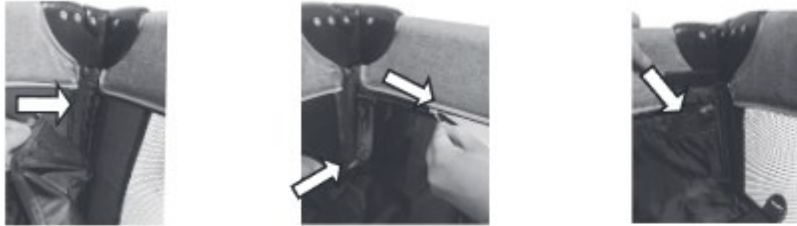

2. Thread the tubes into the pockets on the bassinet. There are pockets on either end of the bassinet.
3. Connect the tubes together by inserting them into one another.
4. There are 2 sets of tubes that need to be parallel to each other.
5. Once the bassinet is zipped on, the tubes are inserted and the bassinet is firm. Then place the mattress on top of the poles.



## 3. CHANGING TABLE INSTRUCTION:

1. Connect the 2 short end bars together.
2. Attach the diaper changing table by hooking the plastic hooks on the long side rails. Make sure all the hooks are securely engaged with the rails.



6

## 4. DAYBED INSTRUCTION:

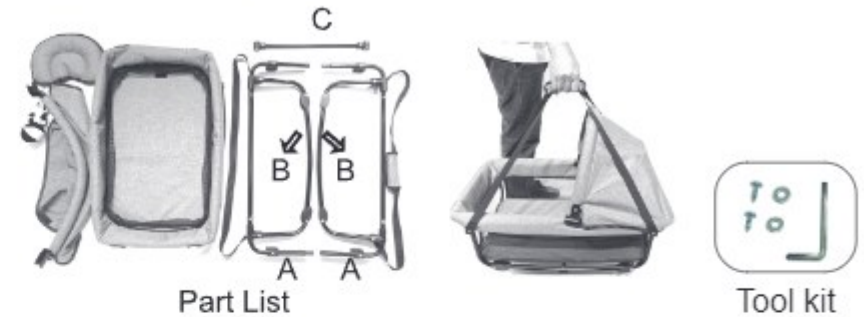

1. Place the daybed inside of the bassinet with the head support at either as shown.
2. Insert the tube into the channel on the inside of the bassinet as shown. Pull open channel for insertion.
3. Insert metal tube into plastic tube. Make sure the button clicks into place as shown.
4. Insert opposite metal tube into plastic tube. Make sure the button clicks into place as shown.



c)



d)



e)

7

## 5. ATTACH THE MUSIC BOX AND MOSQUITO NET INSTRUCTION:

1. Attach the music box on the top side rail as shown.



2. Attach the mosquito net on the top corner first, and then fix the button of the mosquito net on the handrail as shown.



## 6. DROP SIDE INSTRUCTION:



1. The one long side of the camp cot can be lowered and the camp cot can be placed next to a bed.

2. To lower the side rail, unzip the material on the side of the camp cot and press the buttons to lower the rail.

3. Roll out the fabric and bind it with the velcro strap.

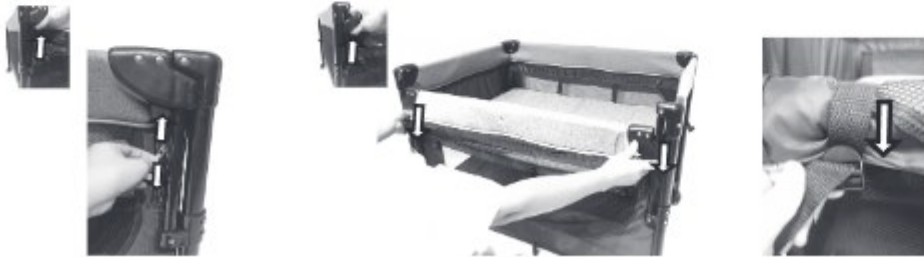

## 7. ATTACH TO ADULT BED :

To attach the camp cot to your bed, see pictures below.



Fixed disk



Lock catch



Fixed ribbon

**⚠** Keep baby from dropping down and harm .  
Never leave your child unattended.





6. Please note, that any repair which will need to be made to this product must be done at the Chelino workshop which is situated at 12 Kimberlite Road, Theta Ext, Booysens Reserve, 2091, Johannesburg, Gauteng, RSA. Our offices hours are Monday to Thursday from 9:00 am to 13:00 pm and 14:00 pm to 16:30 pm and Fridays from 9:00 am to 12:00 pm and 14:00 pm to 16:30 pm. Our offices are closed on Saturdays, Sundays, Public holidays and for three weeks during the December/ January festive season. We do not provide any loan\courtesy products while your product has been sent in for repairs. Chelino requires 7 working days to repair any product, but this lead time may vary depending on the transportation of the product too and from yourself. Once the warranty card is detached from this product and once this product is used even if used once and if there is a fault, this product will need to be sent to the Chelino Workshop for the repair and no refund\credit\exchange will be allowed. Only a Chelino representative can decide whether the product needs to be replaced\credited\exchanged.
7. Once you are satisfied with the assembly of this product and have read this instruction and agree to the terms stated and are ready to use this product, please ensure that all safety locks are engaged to ensure safe use of this product.
8. Never leave the child unattended or without parent\guardian supervision while in this product, as injury could be caused by other parties intentionally or unintentionally.
9. Never lift or wheel this product while the child is in it. This can cause this product to fold and thus causing injury to the child seated in this product. When confronted with a staircase, no matter how many steps there are, please use the alternatives or remove the child from this product before using the staircase.
10. This product including rails must be fully erected prior to use. Rails must be locked in the upright position.
11. Make sure latches are secure.
12. Do not use this product if the enclosed or attached assembly cannot be strictly adhered to. Do not place cords, straps or similar items that would harm the child. Ensure that the sides are properly latched or locked in place when this product is in use.
13. Do not suspend strings over this product or attach strings to the toy bar.
14. Do not place pads or other objects inside this product that may assist the child in climbing out.
15. Do not use this product if the child is able to climb out unaided or is taller than 89cm. the recommended period for use of this product is for a child under 14kg or less.
16. Never allow the child to stand on the bassinette of this product. This can cause this product to fall over thus causing injury to the child. If the child is able to lift itself up drop the bassinette to the lower level.
17. Do not place this product near to a window where cords from blinds or drapes can strangle a child.

18. Do not use this product if any parts are broken, torn or missing.
19. Do not use a water mattress in this product.
20. Never use plastic bags or cellophane as a mattress cover. This can cause suffocation.
21. This product is designed for the use of only one child. This product cannot accommodate more than one child.
22. Always engage the brake when you are not using this product. Please note, by applying the brake one still cannot leave the child unattended and without parent supervision. If the brake is not engaged properly the product will move.
23. Nappy changers are designed for children up to the weight of 9kg. please do not use the changer for a child over 9kg as this will cause damage to the product and cause injury to the child.
24. Prevent and do not allow any child to climb on to any part of this product. This imbalance of weight can cause this product to topple thus causing injury.
25. Storage compartments are there for convenience and are not suitable for holding large or heavy objects. These areas are also not waterproof or leak proof and spillage can occur.
26. If this product is provided with a mosquito net, please ensure that it is correctly fitted to avoid suffocation.
27. Chelino takes no responsibility and will not be held liable for any damage or injury caused by using this product or if this product is used for any other purposes other than its intended purpose.
28. Please note, there are no warranties or guarantee on any fabric or on the mobile units of this product.

## DIMENSION INFO

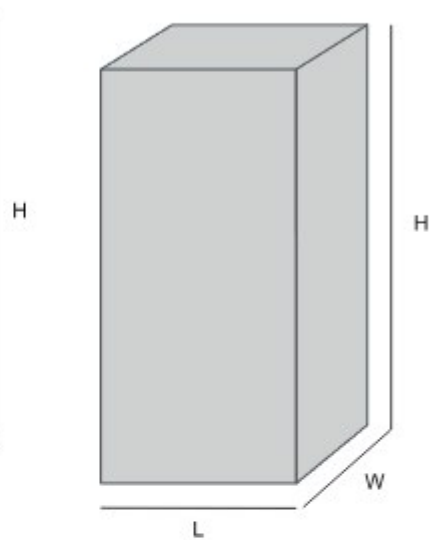

---

LENGTH	98 CM	CARTON LENGTH	34 CM
WIDTH	69 CM	CARTON WIDTH	30.5 CM
HEIGHT	100 CM	CARTON HEIGHT	75 CM

---

WEIGHT	15.00 KGS
--------	-----------